

ROAD TRAFFIC REGULATION ACT 1984

BOROUGH OF READING

(CIVIL ENFORCEMENT AREA)

(WAITING RESTRICTIONS REVIEW A 2016) ORDER 2017

C. J. Brooks
Head of Legal and Democratic Services
Civic Offices
Bridge Street
Reading
RG1 2LU

Legal Ref: CMS/002621

THE BOROUGH OF READING

(CIVIL ENFORCEMENT AREA)

(WAITING RESTRICTIONS REVIEW 2016 A) ORDER 2017

The Reading Borough Council (hereinafter referred to as “the Council”) in exercise of the powers conferred by Sections 1(1), 2(1) to (3), 4(2), and Part IV of Schedule 9 to the Road Traffic Regulation Act 1984 (“the Act of 1984”), as amended and of all other powers thereunto enabling and after consultation with the Chief Officer of Police in accordance with Part III of Schedule 9 to the Act of 1984 and Part 6 of the Traffic Management Act 2004 (“the Act of 2004”), hereby make the following Order:-

PART I
CITATION AND INTERPRETATION

1. This Order may be cited as The Borough of Reading (Civil Enforcement Area) (Waiting Restrictions Review 2016 A) Order 2017 and shall come into operation on the 7 April 2017.

2. In this Order, except where the context otherwise requires, the following expressions have the meanings hereby respectively assigned to them:-

“ambulance” has the same meaning as in the Vehicle Excise and Registration Act 1994;

“authorised agent” means the parking services contractor appointed by and acting on behalf of the Council for the purposes of the supervision and enforcement of this Order;

“authorised cab rank” means an area of carriageway which is comprised within and indicated by road markings complying with diagram 1028.2 in Schedule 6 to the 2002 Regulations;

“authorised parking place” means any parking place on a road, authorised or designated by this Order;

“carriageway” means a way constituting or comprised in a highway being a way (other than a cycle track) over which the public have a right of way for the passage of vehicles;

“civil enforcement officer” has the same meaning as in section 76 of the Act of 2004;

“disabled person’s badge”, “disabled person’s vehicle” and “parking disc” have the same meanings as in the Local Authorities Traffic Orders (Exemption for Disabled Persons) (England) Regulations 2000;

“driver”, in relation to a vehicle waiting in a parking place or on a road or length of road, means the person driving the vehicle at the time it was left in that parking place or road or length of road;

"goods" means goods or burden of any description and includes postal packets of any description;

"goods vehicle" means a motor vehicle which is constructed or adapted for use for the carriage of goods or burden of any description and which does not exceed 5.30 metres in length or 2.25 metres in height;

"hackney carriage" means a vehicle licensed under Section 37 of the Town Police Causes Act 1847, Section 6 of the Metropolitan Carriages Act 1869, or any similar enactment;

"loading" means the loading or unloading of goods to or from a vehicle;

"motorcycle" and "invalid carriage" have the same meanings as in Section 136 of the Road Traffic Act of 1984;

"owner", in relation to a vehicle, has the same meaning as in Section 92(1) of the Act of 2004 or the person who has the use of such a vehicle in the course of his/her employment and is entitled to use such a vehicle as though he/she were the registered keeper thereof;

"parking place" has the same meaning given by section 79(7) of the Act of 2004;

"passenger vehicle" means a motor vehicle (other than a motor cycle or invalid carriage) not exceeding 5.30 metres in length and 2.25 metres in height and constructed or adapted for the carriage of passengers and their effects;

"penalty charge" has the same meaning as in section 92(1) of the Act of 2004;

"penalty charge notice" has the same meaning as in section 8(1) of The Civil Enforcement of Parking Contraventions (England) General Regulations 2007;

"permit" means a permit issued under the provisions of Articles 17 to 25;

"permit holder" means a person to whom a permit has been issued;

"permitted hours" means 24 hours Monday to Sunday unless otherwise stated in Article 5 to this Order;

"relevant position" in respect of: -

- (a) a parking permit, means
 - (i) in the case of a vehicle fitted with a front windscreen, that the badge or permit is exhibited thereon with the front facing forward on the nearside of and immediately behind the windscreen; or
 - (ii) the case of a vehicle not fitted with a front windscreen, that the badge or permit is exhibited on the front or nearside of the vehicle;

- (b) a disabled person's badge, in accordance with Section 12 of The disabled Persons (Badges for Motor Vehicles) (England) Regulations 2000;

"resident" means a person whose usual place of abode is at premises the postal address of which is in a road or part of a road specified in Schedule 9;

"specified position" a vehicle left in a parking place during the permitted hours in accordance with the foregoing provisions of this Order shall cause it so to stand so that every part of a vehicle is within the limits of a parking place.

"telecommunication system" has the same meaning as in the Telecommunications Act 1984;

"The 2002 Regulations" means the Traffic Signs Regulations and General Directions 2002;

- 3. The prohibitions imposed by this Order shall be in addition to and not in derogation of any restriction, prohibition or requirement imposed by any Regulations or Orders made or having effect as if made under the Act of 1984, or by or under any other enactment.
- 4. Save where the contrary is indicated, any reference in this Order to:-
 - (a) a numbered Article or Schedule is a reference to the Article or Schedule bearing that number in this Order;
 - (b) this Order or another Order shall be construed as such a reference to this Order or, as the case may be, such other Order, as the same may have been or may from time to time be amended, varied or supplemented;
 - (c) a Statute or Regulation shall be construed as reference to such Statute or Regulations as the same may have been, or may from time to time be amended or re-enacted.
 - (d) The requirements of any Article making reference to a numbered Schedule to this Order shall only have effect when a Schedule similarly numbered is appended to this Order.

PART II

WAITING AND LOADING OF VEHICLES

- 5. Save as provided in Articles 6 and 7 no person shall, except upon the direction or with the permission of a Police Constable in uniform or a civil enforcement officer, cause or permit any vehicle during each separately dated day, to:-
 - (a) wait at any time on Mondays to Sundays inclusive in the lengths of roads specified in Schedule 1;
 - (b) wait between the hours of 12.00 noon and 1.30 pm on Mondays to Fridays inclusive in the lengths of roads specified in Schedule 2;

- (c) wait between the hours of 11.00 a.m. and 12.00 noon on Mondays to Fridays inclusive in the lengths of roads specified in Schedule 3;
 - (d) wait between 8.00 a.m. and 6.30 p.m. on Mondays to Saturdays inclusive in the lengths of roads specified in Schedule 4 for a longer period than 30 minutes or, if a period of less than 30 minutes has elapsed since the previous period of waiting by the same vehicle in the same length of road;
 - (e) wait between 8.00 a.m. and 6.30 p.m. on Mondays to Saturdays inclusive in the lengths of roads specified in Schedule 5 for a longer period than 2 hours or, if a period of less than 2 hours has elapsed since the previous period of waiting by the same vehicle in the same length of road;
 - (f) wait between 8.00 a.m. and 4.00 p.m. on Mondays to Fridays inclusive in the lengths of roads specified in Schedule 6 for a longer period than 4 hours or, if a period of less than 2 hours has elapsed since the previous period of waiting by the same vehicle in the same length of road, except for vehicles displaying a valid parking permit;
6. Nothing in Article 5 shall apply to any vehicle waiting in the lengths of roads referred to therein for so long as it may be necessary to enable:-
- (a) a person to board or alight from the vehicle;
 - (b) the vehicle, if it cannot conveniently be used for such purpose in any other road, to be used in connection with any of the following operations, namely:-
 - (i) building, industrial or demolition operations;
 - (ii) the removal of any obstruction to traffic;
 - (iii) the maintenance, improvement or reconstruction of the said lengths of roads;
 - (iv) the laying, erection, alteration or repair in or in land adjacent to the said lengths of roads of any sewer or of any main, pipe or apparatus for the supply of gas, water or electricity or of any telecommunications system;
 - (v) the service of a Local Authority or a Water Authority in pursuance of statutory powers or duties;
 - (c) the vehicle to be used for the purpose of providing a postal service as defined in section 27 Postal Services Act 2011;
 - (d) the vehicle to take in petrol, oil, water or air from any garage situated on or adjacent to the said lengths of roads;
 - (e) the vehicle to wait at or near to any premises situated on or adjacent to the said lengths

of roads for so long as such waiting by that vehicle is reasonably necessary in connection with any wedding or funeral;

(f) the vehicle being used for fire brigade, ambulance or police purposes.

7. (1) Nothing in Article 5 shall apply:-

- (a) to any vehicle waiting for so long as may be necessary for the purpose of enabling goods to be loaded on or unloaded from the vehicle;
- (b) to a Disabled Person's Vehicle, displaying a Disabled Person's Badge in accordance with Section 12 of The Disabled Persons (Badges for Motor Vehicles) (England) Regulations 2000;
- (c) to a Disabled Person's Vehicle, displaying a Disabled Person's Badge in the relevant position, waiting on the lengths of roads specified in Schedules 4, 5, 6, 7 and 8 during the specified limited waiting hours;

provided that such exemptions do not apply during the hours when loading restrictions are imposed by that Article.

(2) Nothing in Article 5 shall apply to any vehicle:-

- (a) waiting upon an authorised parking place; or
- (b) being a Hackney Carriage, waiting upon an authorised cab rank; or
- (c) waiting for so long as may be necessary to enable the vehicle to be used in the provision of a local service within the meaning of the Transport Act 1985.

PART III

AUTHORISATION AND USE OF PARKING PLACES

8. (1) (1) The lengths of roads specified in Schedule 7 are authorised to be used:

- (a) as parking places for the parking during the permitted hours as are specified in the said Schedule, of a vehicle displaying in the relevant position a valid Residents Parking Permit issued by the Council AND
- (b) for vehicles to wait between 8.00am and 8.00pm on Mondays to Sundays inclusive for a period of 2 hours excepting if a period of less than 2 hours has elapsed since the previous period of waiting by the same vehicle in the same length of road.

- (2) The lengths of roads specified in Schedule 8 are authorised to be used as parking places for the parking during the permitted hours and in such positions as are specified in the said Schedules, of a vehicle displaying in the relevant position a valid Residents Parking Permit issued by the Council.
9. Where in the Schedules a parking place is described as available for vehicles of a specific class or in a specified position, the driver of a vehicle shall not permit it to wait in the parking place unless it:-
- (a) is of the specified class; or as the case may be -
 - (b) is in the specified position;
 - (c) displays a valid parking permit issued by the Council.
10. A driver of a vehicle shall not use a parking place:-
- (a) so as to unreasonably prevent access to any premises adjoining the road, or the use of the road by any other person, or so as to be a nuisance;
 - (b) when a Police Constable in uniform, Civil Enforcement Officer or a or a person authorised by the Council has closed the parking place.
11. The driver of a motor vehicle using a parking place shall stop the engine as soon as the vehicle is in position in the parking place and shall not start the engine except when about to change the position of the vehicle in, or to depart from, that parking place.
12. No person shall use a vehicle whilst it is in a parking place in connection with the sale of any article to persons in or near the parking place, or in connection with the selling or offering for hire of his skill or services.
13. When a vehicle is left in a parking place in contravention of the provisions of Articles 9(b), a Police Constable in uniform, Civil Enforcement Officer or a parking attendant or a person authorised by the Council to do so may alter or cause to be altered the position of the vehicle so that its position shall comply with that provision.
14. Any person altering the position of a vehicle by virtue of Article 15 may do so in such manner as he thinks necessary.
15. A Police Constable in uniform, Civil Enforcement Officer or a person authorised by the Council to do so may, in case of emergency, or in contravention of Article 10, remove or cause to be removed to any place he thinks fit any vehicle left in a parking place.
16. Any person removing or causing to be removed a vehicle from a parking place in accordance with Article 15 shall provide for the safe custody of the vehicle.

PART IV
PERMITS

17. (1) Any resident or doctor, who is the owner of a vehicle of the following class, that is to say a passenger vehicle, a goods vehicle, a invalid carriage or a motorcycle may apply to the Council or an authorised agent for a permit for the parking of that vehicle in a parking place specified in paragraph (5) of this Article and any such application shall be made on a form issued by and obtainable from the Council or authorised agent and shall include the particulars and information required by such form to be supplied.
- (2) The Council or authorised agent may at any time require an applicant for a permit or a permit holder to produce to an officer of the Council or authorised agent such evidence in respect of an application for a permit as they may reasonably require to verify the particulars or information given to them or to verify that the permit is valid.
- (3) The Council or authorised agent upon being satisfied that the applicant is a resident who is the owner of a vehicle of the class specified in paragraph (1) of this Article, shall issue to the applicant a Residents Parking Permit for the leaving during the permitted hours in a parking place of the vehicle to which such permit relates, by the owner or by any person using such vehicle with the consent of the owner (other than a person to whom such vehicle has been let for hire and reward);
- (4) A resident shall not be entitled to be in possession of more than one permit at any one occasion.
- (5) A Residents Parking Permit shall only be a valid for use in a parking place specified in Schedule 7;
18. Notwithstanding the provisions contained in Article 17 the Council may also grant permits to such other persons as they may think fit.
19. (1) A permit holder, may surrender such permit to the Council or authorised agent at any time and shall surrender such permit to the Council or authorised agent on the occurrence of any one of the events set out in paragraph (3) of this Article.
- (2) The Council or authorised agent may, by notice in writing served on the permit holder at the address shown by that person on the application for the permit or at any other address believed to be that person's residence, withdraw a permit if it appears to the Council or authorised agent that any one of the events set out in paragraph (3) of this Article has occurred and the permit holder shall surrender the permit to the Council or authorised agent within 48 hours of the receipt of the aforementioned notice.
- (3) The events referred to in the foregoing provisions of this Article are:-

- (a) the permit holder ceasing to be a resident;
 - (b) the permit holder ceasing to be the owner of the vehicle in respect of which the permit was issued;
 - (c) the vehicle in respect of which such permit was issued being adapted or used in such a manner that it is not a vehicle of the class specified in Article 17(1);
 - (d) the issue of a duplicate permit by the Council under the provisions of Article 22;
 - (e) the expiry of the period for which the permit was issued;
 - (f) where a permit is issued to any person upon receipt of a cheque and the cheque is subsequently dishonoured, the permit shall cease to be of any effect;
20. Without prejudice to the provisions of Article 19, a permit shall cease to be valid at the expiration of the period specified thereon:-
- (a) which period, in the case of a Residents Permit, shall not exceed a period of twenty-three months from the end of the month during which it first became valid;
 - (b) or on the occurrence of any one of the events set out in paragraph (3) of Article 19, whichever is the earlier.
21. (1) If a permit is accidentally mutilated or defaced or the figures or particulars thereon have become illegible or the colour of the permit has become altered by fading or otherwise, the permit holder shall surrender it to the Council or authorised agent and apply to the Council or authorised agent for the issue to him of a duplicate permit, whereupon Council or authorised agent, shall issue a duplicate permit so marked and upon such issue the original permit shall become invalid.
- (2) If a permit is lost or destroyed, the permit holder may apply to the Council or authorised agent for the issue to him of a duplicate permit and the Council or authorised agent upon being satisfied as to such loss or destruction, shall issue a duplicate permit so marked and upon such issue the permit shall become invalid.
- (3) All the provisions of this Order shall apply to a duplicate permit to the same extent as they applied to the original permit.
22. A permit shall be in writing and shall include the following particulars:-
- (a) the registration mark of the vehicle in respect of which the permit has been issued;
 - (b) the period during which, subject to the provisions of Article 19, the permit shall remain valid;

- (c) an authentication that the permit has been issued by the Council;
 - (d) a code indicating the parking area for which the permit is valid.
23. At all times during which a vehicle is left in a parking place specified in Schedules 7 or 8 during the permitted hours, there shall be displayed in the relevant position a permit issued in respect of that vehicle valid for parking place.
24. When a permit has been displayed in accordance with the provisions of Article 23, or where a penalty charge notice has been attached to the vehicle, no person other than a Police Constable in uniform, Civil Enforcement Officer or a parking attendant shall remove such permit or notice from the vehicle unless authorised to do so by the driver of that vehicle.
25. Notwithstanding the foregoing provisions of this Order, the Council may at its discretion issue a discretionary Notice allowing a specific vehicle to wait in a road or a parking place during the hours of operation of any restriction or prohibition to the contrary.

PART V
REVOCATIONS

26. The following items contained within orders detailed below shall be revoked:

Borough of Reading (Portman Road Zone E) (Special Parking Area) (Waiting Restrictions and Parking Places) Consolidation Order 2007
Schedule 4, Item 62, Loverock Road, North Side

Borough of Reading (Civil Enforcement Area) (Waiting Restrictions Review B 2014) Order 2015
Schedule 4, Item 18, Wealden Way, South side

Borough of Reading (Civil Enforcement Area) (Waiting Restrictions Review 2015A) Order 2015
Schedule 4, Southcote Road, West side

Borough of Reading (Green Road) (Waiting Restrictions and Movement Control) Order 2012
Schedule 1, Green Road, both sides

Borough of Reading (Civil Enforcement Area) (Waiting Restrictions Review 2015A) Order 2015
Schedule 4, Southcote Lane, Northwest Side

Borough of Reading (Tilehurst Zone J) (Special Parking Area) (Waiting Restrictions and Parking Places) Consolidation Order 2006
Schedule 23, item 128 St Michaels Road, Northeast side

Borough of Reading (Tilehurst Zone J) (Special Parking Area) (Waiting Restrictions and Parking Places) Consolidation Order 2006
Schedule 24, item 156 St Michaels Road, Northeast side

Borough of Reading (Tilehurst Zone J) (Special Parking Area) (Waiting Restrictions and Parking Places) Consolidation Order 2006
Schedule 23, item 129 St Michaels Road, Southwest side

Borough of Reading (Tilehurst Zone J) (Special Parking Area) (Waiting Restrictions and Parking Places) Consolidation Order 2006
Schedule 4, item 42, St Michaels Road, Southwest side

Borough of Reading (Tilehurst Zone J) (Special Parking Area) (Waiting Restrictions and Parking Places) Consolidation Order 2006
Schedule 4, item 64, Woodland Drive, northwest side

Borough of Reading (Newtown East) (Residents Parking Restrictions) (Amendment) Order 2013
Schedule 58 Items 1-27

Borough of Reading (Hemdean Zone B) (Special Parking Area) (Waiting Restrictions and Parking Places) Consolidation Order 2006
Schedule 25 Item 134 Gosbrook Road, south side.

Borough of Reading (Hemdean Zone B) (Special Parking Area) (Waiting Restrictions and Parking Places) Consolidation Order 2006
Schedule 99, item 176 Gosbrook Road south side

THE COMMON SEAL of the READING)
BOROUGH COUNCIL was hereunto)
affixed this 30th day of March 2017)
in the presence of: -)

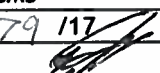
Minute	TMSub Com 13/6/2016 M.N.H.
Originator	CMS
Seal No.	79/117
Checked	

Authorised Signatory

KEY
EXISTING RESTRICTIONS
 No Waiting At Any Time
PROPOSED RESTRICTIONS
 As labelled

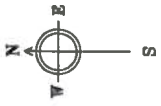

Project Waiting Restrictions Review 2016A	Scale NTS	Drawn JC
	Date MAY 2016	Checked JC
Drawing WEALDEN WAY	Drawing No. WRR/2016A/KE4	Approved 58

Department of Environment
 and Neighbourhood Services
 Civic Centre
 Reading
 RG1 7AE





CRESCENT ROAD

WESTWOOD ROAD

PROPOSED NO
WAITING AT ANY TIME

68

110

53

104

68

59

7

KEY

EXISTING RESTRICTIONS

— No waiting at any time

PROPOSED RESTRICTIONS

As labelled

Crown copyright and database rights 2013 Ordnance Survey 100019672



Reading
Borough Council

Working better with you

Department of Environment
Culture and Sport
Civic Centre
Reading
RG1 7AE

Project
WAITING RESTRICTION
REVIEW 2016A

Drawing

WESTWOOD ROAD

Scale N.T.S.

Date MAY 2016

Drawing No. WRR/2016A/T14

Drawn JC

Checked JC

Approved JC

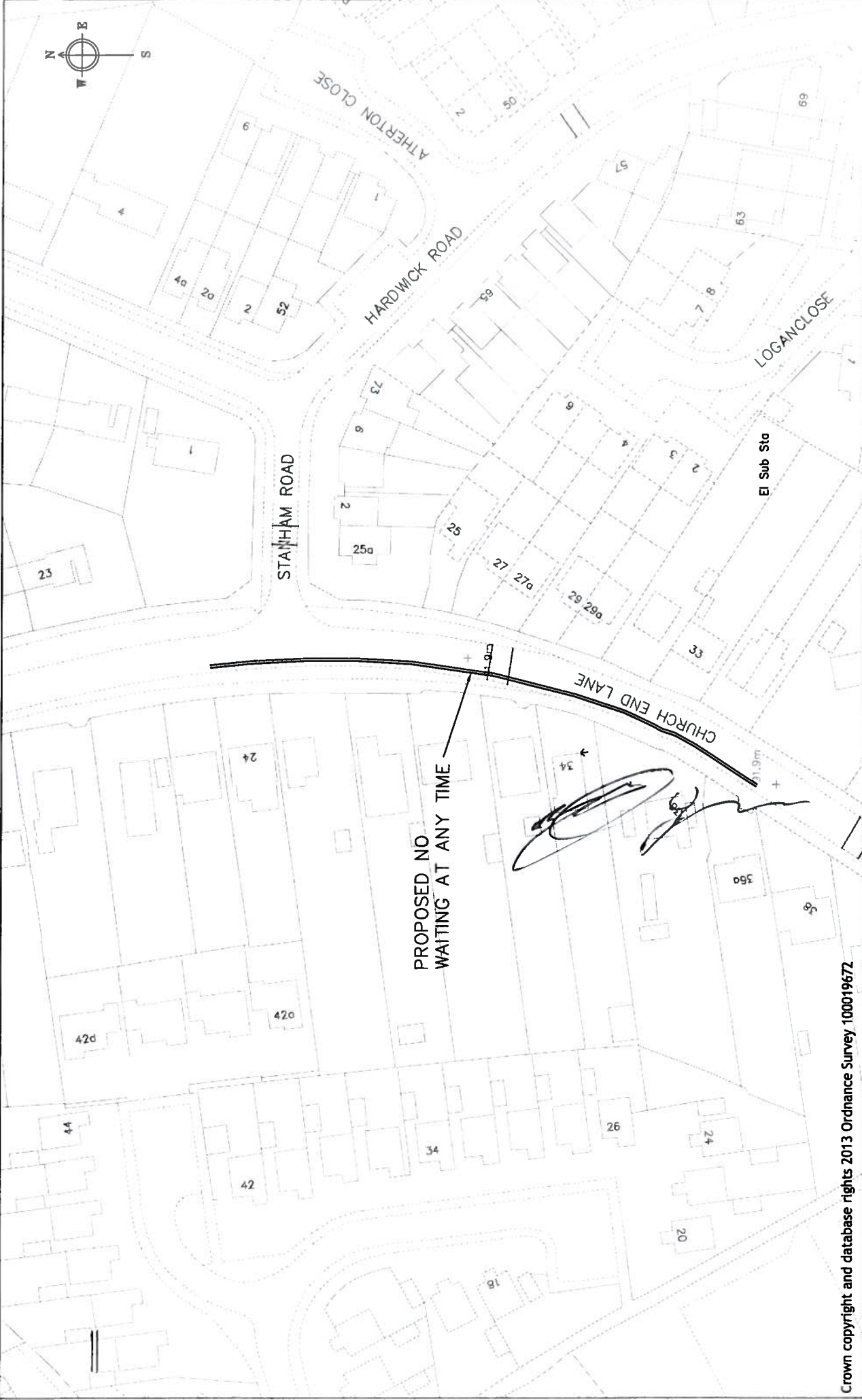

Crown copyright and database rights 2013 Ordnance Survey 100019672



Reading
Borough Council
Working better with you

Department of Environment
and Neighbourhood Services
Civic Centre
Reading
RG1 7AE

Project

WAITING RESTRICTION
REVIEW 2016A

Drawing

CHURCH END LANE

Scale

N.T.S

Drawn

JC

Date

MAY 16

Checked

JC

Approved

JC

Drawing No.

WRR/2016A/T11

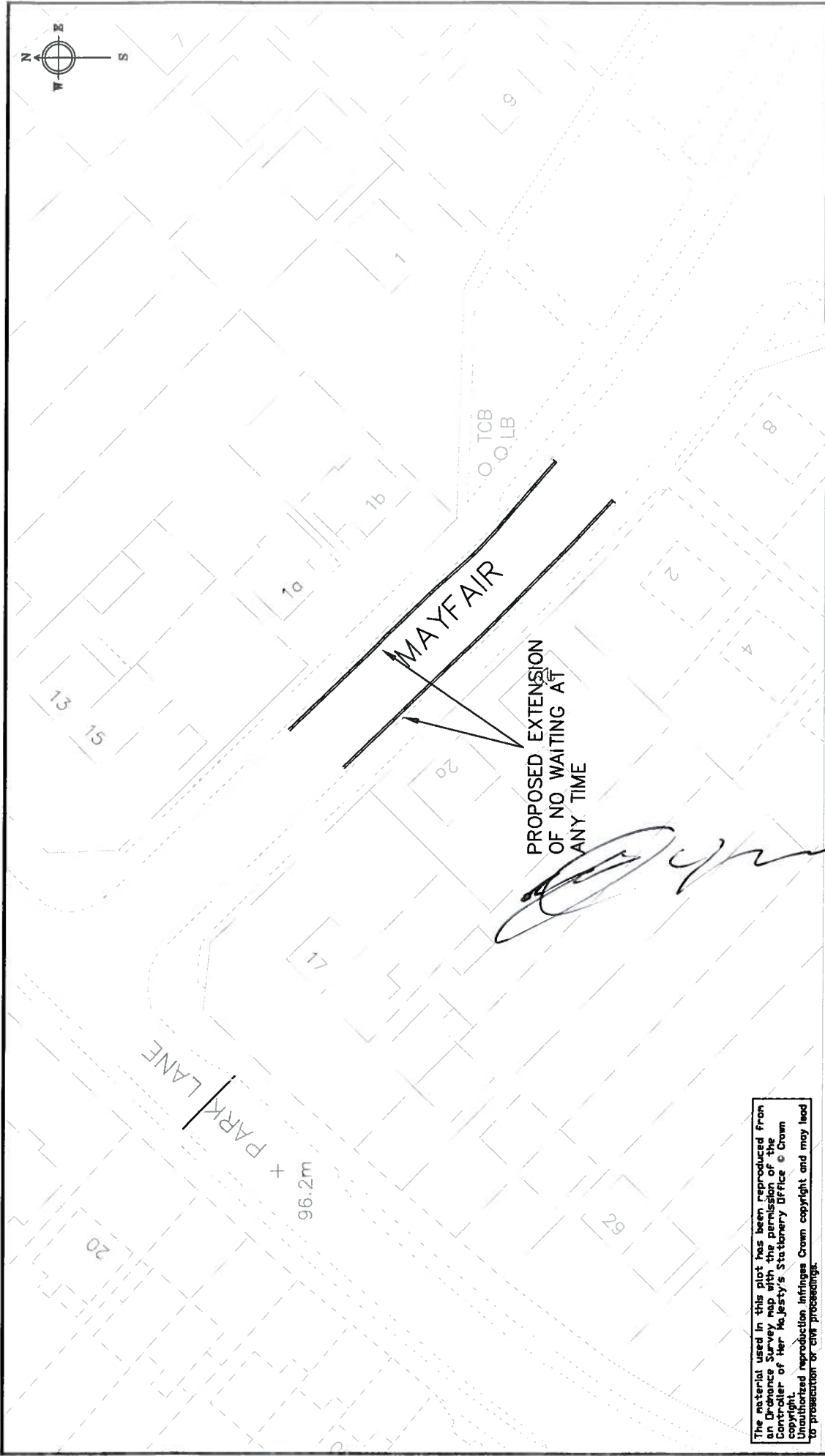
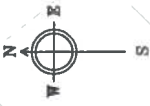

The material used in this plot has been reproduced from an Ordnance Survey map with the permission of the Controller of Her Majesty's Stationery Office © Crown Copyright. Unauthorised reproduction infringes Crown copyright and may lead to prosecution or civil proceedings.
 © Crown Copyright. All rights reserved. Reading Borough Council. Account No. 100019672. 2007

Department of Environment Culture and Sport Civic Centre Reading RG1 7TD		project WAITING RESTRICTION REVIEW 2016A		FAD Drawing Location scale N.T.S		drawn PC	checked JC
S:\Drawing Frames\Reading.jpg		drawing MAYFAIR/PARK LANE		approved JC date MAY 2016		drawing no. WRR16A/T12	

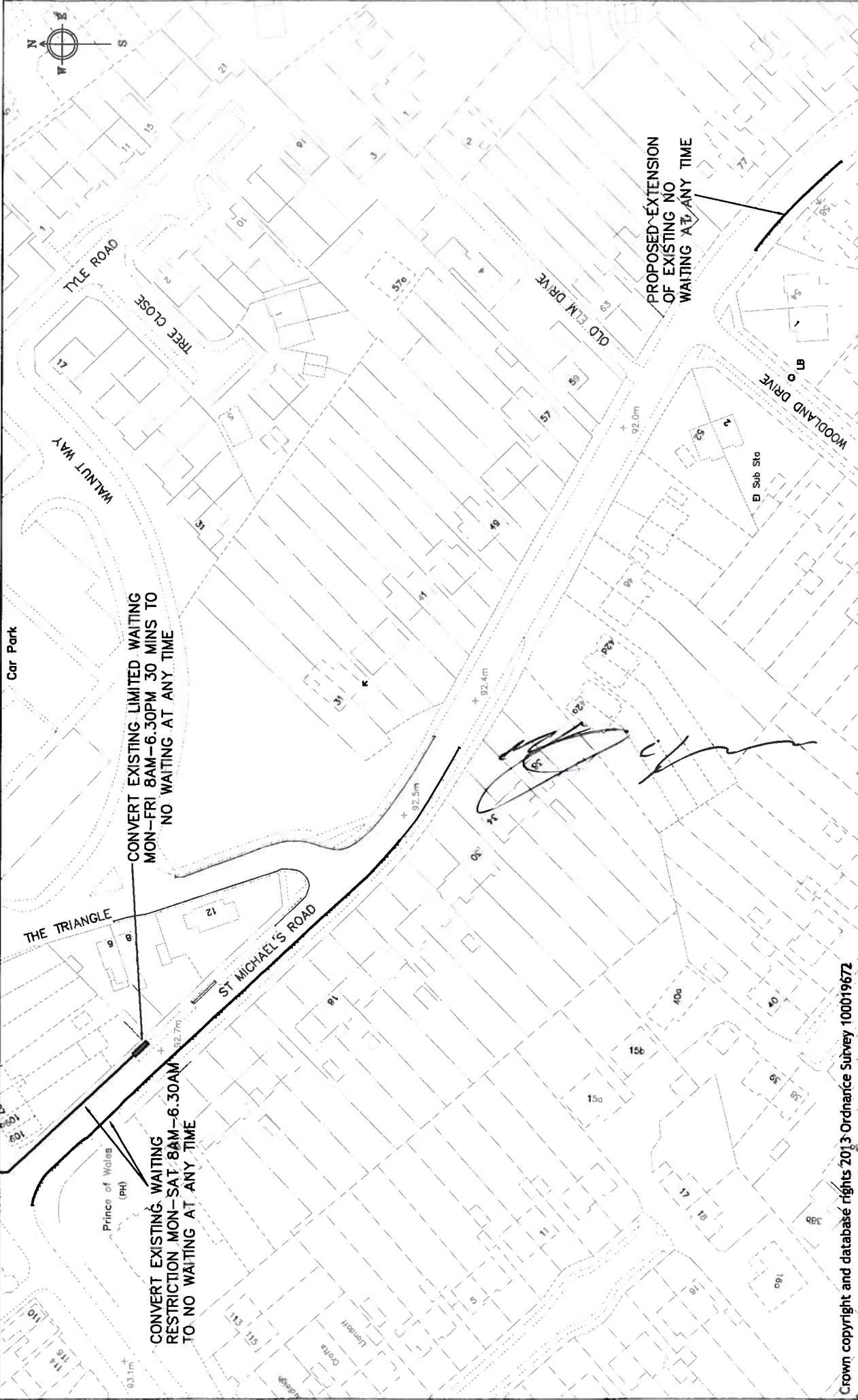

Crown copyright and database rights 2013 Ordnance Survey 100019672

Project	Scale	Drawn	JT
	N.T.S.	Checked	JC
Drawing	Date	Approved	JC
	MAY 2016	Drawing No.	WRR16A/TI3_A

WAITING RESTRICTION REVIEW 2016A
ST MICHAEL'S ROAD
 Transportation & Streetcare Services
 Civic Offices
 Reading
 RG1 2LU

Reading Borough Council
 Working better with you

KEY
EXISTING RESTRICTIONS
 No Waiting At Any Time
PROPOSED RESTRICTIONS
 As labelled



POTTERY ROAD

PROPOSED NO WAITING AT ANY TIME

[Handwritten Signature]

Project	Waiting Restrictions Review 2016A		Scale	NTS	Drawn	JC
	Drawing		Date	MAY 2016	Checked	JC
		Drawing No.		WRR/2016A/KE4		

Department of Environment
 and Neighbourhood Services
 Civic Centre
 Reading
 RG1 7AE

Reading
 Borough Council
 Working better with you



NORTHCOURT AVENUE

ENNERDALE ROAD

PROPOSED NO WAITING
AT ANY TIME

71

71a

73

40

44

2a

2

46

48



Reading
Borough Council

Working better with you

Department of Environment
and Neighbourhood Services
Civic Centre
Reading
RG1 7AE

Project

Waiting Restrictions Review
2016A

Drawing

Ennerdale Road

Scale

NTS

Date
MAY 2016

Drawn

Checked

Approved

JC

JC

JC

Drawing No.

WRR/2016A/CH2

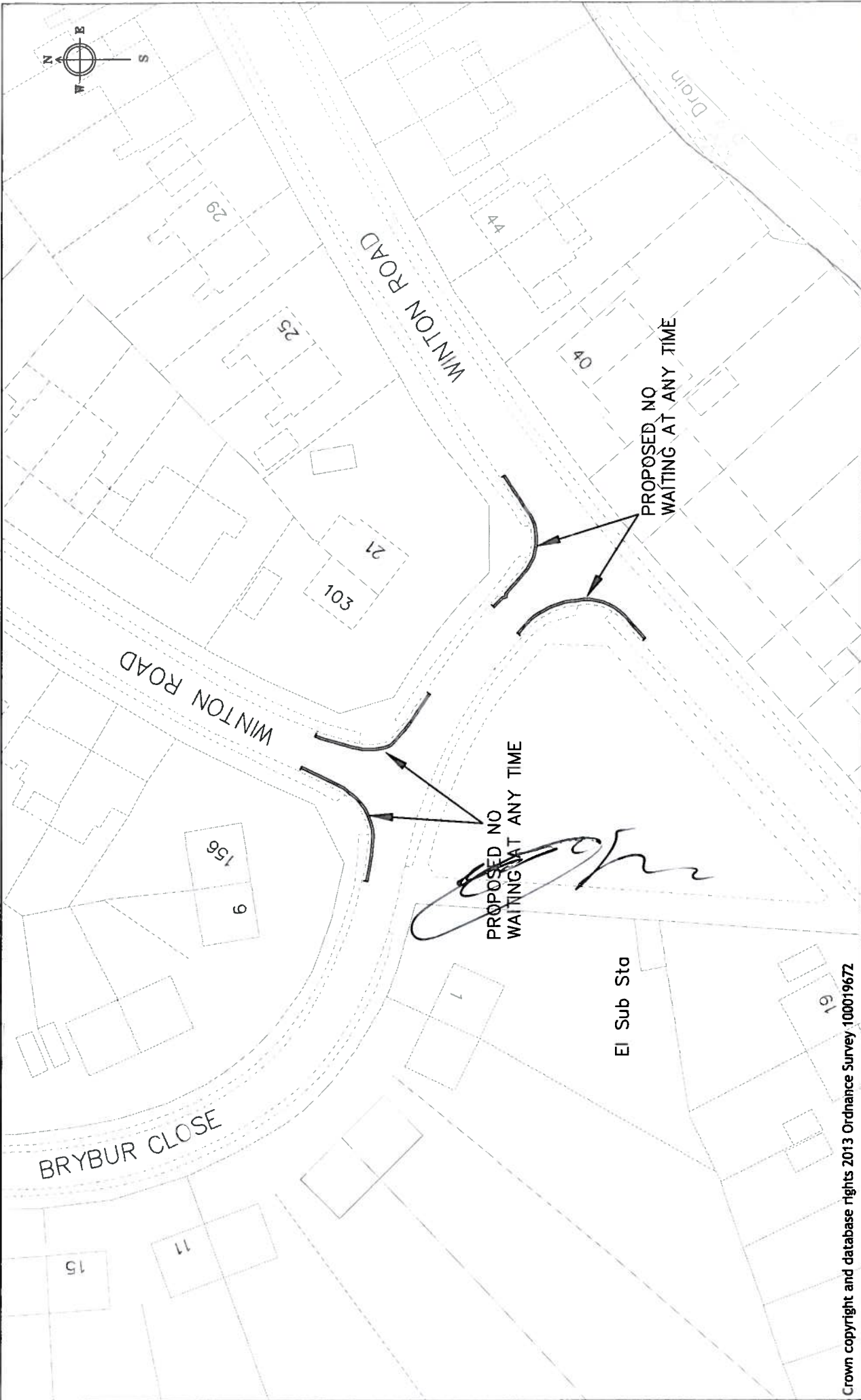

Crown copyright and database rights 2013 Ordnance Survey 100019672

 <p>Reading Borough Council Working better with you</p>	<p>Department of Environment and Neighbourhood Services Civic Centre Reading RG1 7AE</p>	
	<p>Project WAITING RESTRICTION REVIEW 2016A</p>	<p>Scale N.T.S</p>
<p>Drawing WINTON ROAD</p>	<p>Date MAY 15</p>	<p>Checked JC Approved JC</p>
<p>Drawing No. NM/AWRR/2016A/CH1</p>		

KEY

PROPOSED RESTRICTIONS
As labelled

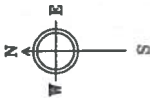

Existing permit holders only bay

Convert 6m of existing permit only bay to no waiting at any time

Convert 17m of existing 2hr limited waiting bay to no waiting at any time

Existing 2hr limited waiting bay

El
Sub
Sta

88 to
110

56

68

Shelter

GOSBROOK ROAD

[Handwritten signature]

37.8m +

The material used in this plot has been reproduced from an Ordnance Survey map with the permission of the Controller of Her Majesty's Stationary Office © Crown copyright. Unauthorized reproduction infringes Crown copyright and may lead to prosecution or civil proceedings.

© Crown Copyright. All rights reserved. Reading Borough Council. Account No. 100019672.2007



Reading
Borough Council

Working better with you

Directorate of Environment and
Neighbourhood Services
Civic Centre, Bridge Street
Reading
RG1 2LU

project
ANNUAL PARKING REVIEW - 2016B

drawing
Gosbrook Road Caversham

CAD Drawing Location: S/INH/SPA11/CirConsultation

scale	drawn	JT	checked	JC
N.T.S	approved	JC		
	date	JUL 2016		

drawing no.
WRR/2016A/CA1

KEY
EXISTING RESTRICTIONS
 No Waiting At Any Time
PROPOSED RESTRICTIONS
 As labelled

LITTLEJOHN'S LANE

38.0m

OSL

PROPOSED EXTENSION OF
 WORK NO WAITING AT ANY TIME

LOVEROCK ROAD



The material used in this plan has been reproduced from an Ordnance Survey map with the permission of the Controller of Her Majesty's Stationery Office © Crown Copyright. Unauthorised reproduction infringes Crown copyright and may lead to prosecution or civil proceedings.

© Crown Copyright. All rights reserved. Reading Borough Council. Account No. 100019872. 2007



Department of Environment
 Culture and Sport
 Civic Centre
 Reading
 RG1 7TD

project	WAITING RESTRICTION REVIEW 2016A	scale	N.T.S	DRAWN PC	CHECKED PC
	drawing	LOVEROCK ROAD	drawing no.	APPROVED JC	
				DATE	MAY 2016
					WRR16/BA2

KEY

EXISTING RESTRICTIONS
No waiting at any time

PROPOSED RESTRICTIONS
As labelled

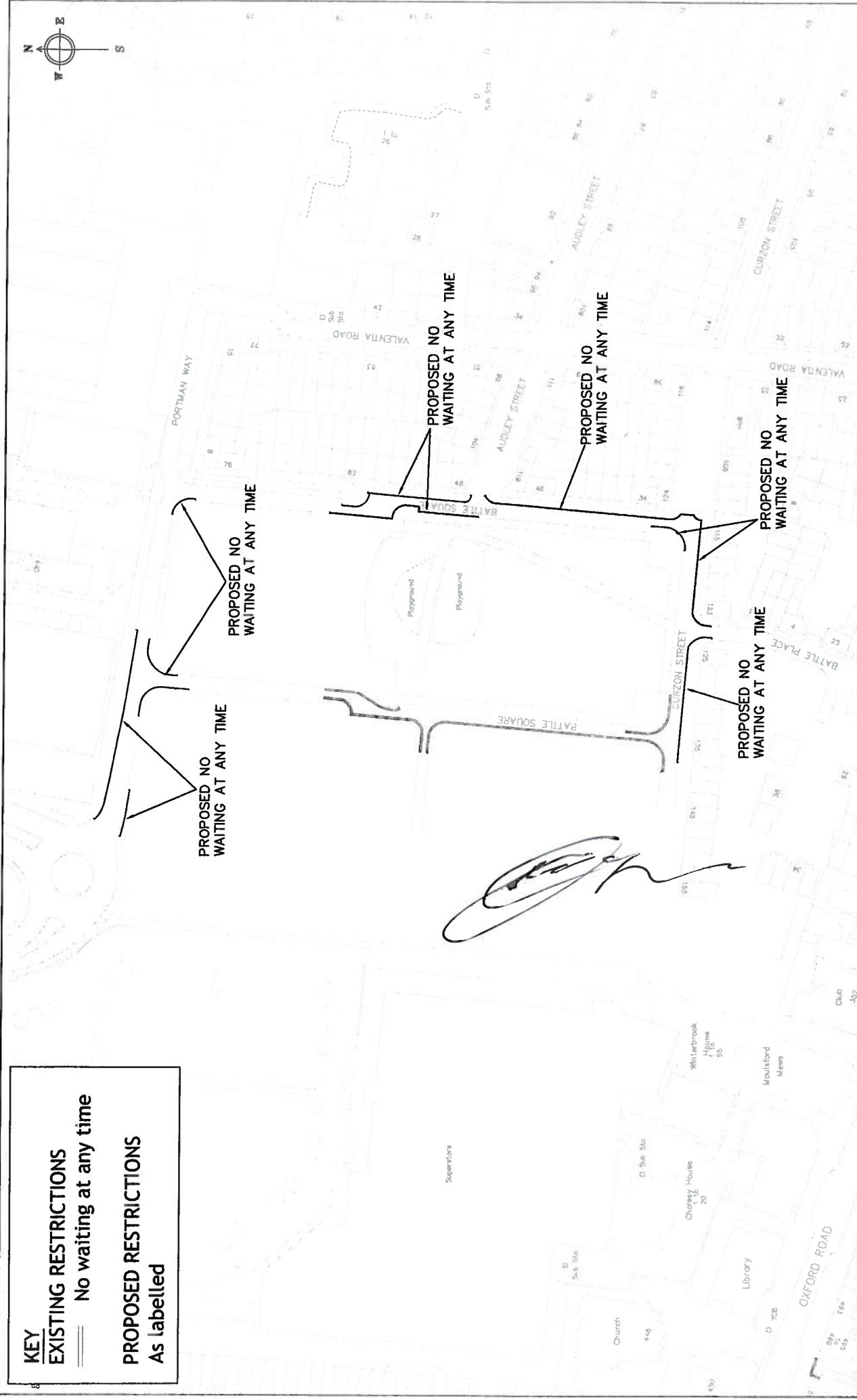
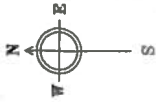

Reading
Borough Council
Working better with you

Department of Environment
and Neighbourhood Services
Civic Centre
Reading
RG1 7AE

Project	Waiting Restrictions Review 2016A	
	Drawing	
Battle Square		Drawing No.

Scale	Drawn	JC
	Checked	JC
Date	Approved	JC
	MAY 2016	
Drawing No.		WRR/2016A/BA1

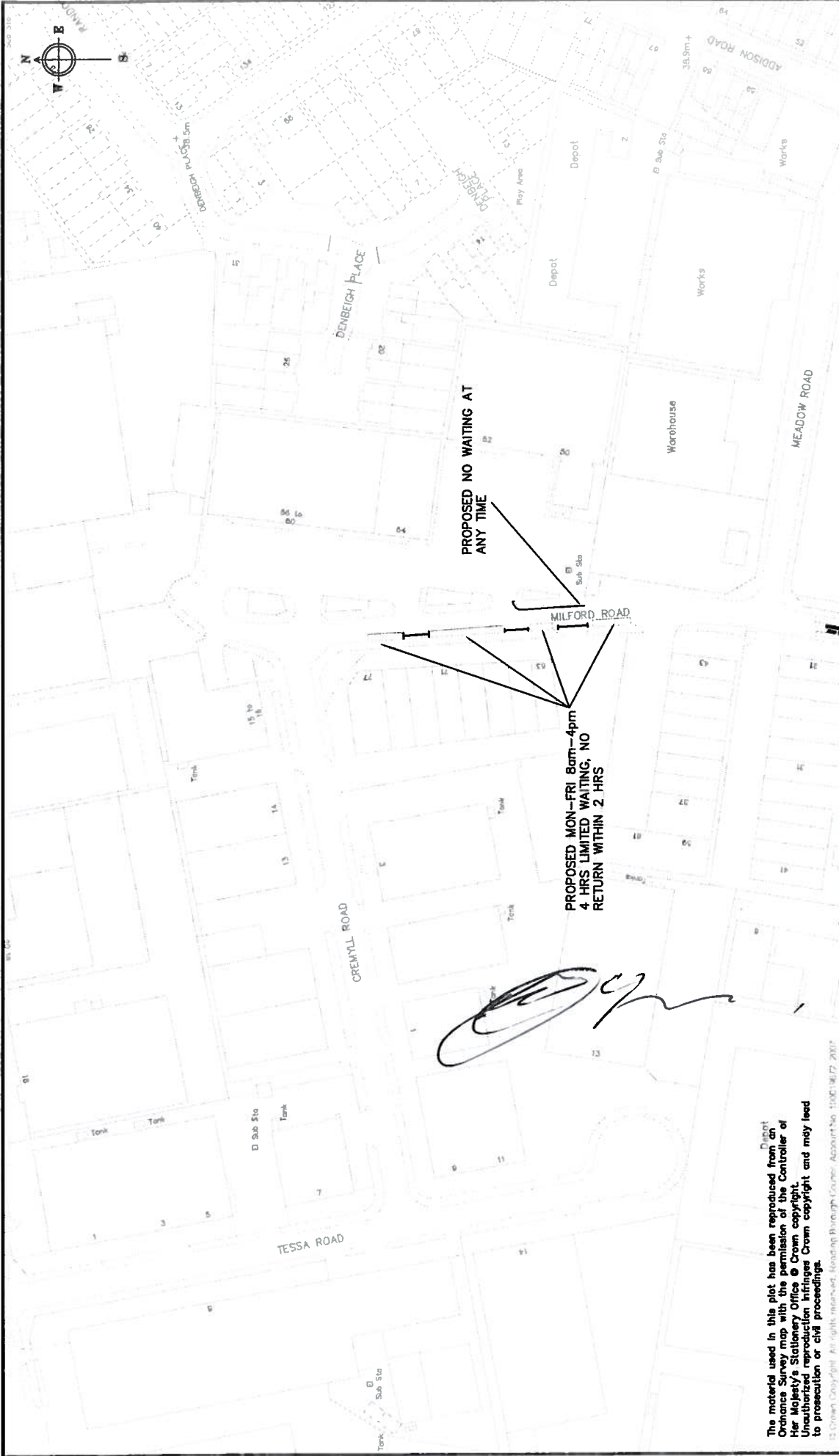

PROPOSED NO WAITING AT ANY TIME

PROPOSED MON-FRI 8am-4pm
4 HRS LIMITED WAITING, NO RETURN WITHIN 2 HRS

The material used in this plot has been reproduced from an Ordnance Survey map with the permission of the Controller of Her Majesty's Stationery Office © Crown copyright. Unauthorized reproduction infringes Crown copyright and may lead to prosecution or civil proceedings.

project WAITING RESTRICTION REVIEW 2016A	scale N.T.S	drawn JC approved JC	checked JC
	drawing no. MILFORD ROAD	date MAY 2016	WRR16A/AB1
Department of Environment Culture and Sport Civic Centre Reading RG1 7TD		S:\Drawing Frames\Reading.jpg	

KEY

EXISTING RESTRICTIONS

==== No waiting at any time

PROPOSED RESTRICTIONS

As labelled



PROPOSED NO
WAITING AT ANY TIME

PROPOSED NO
WAITING AT ANY TIME

Palmer
to
9

CARMELITE DRIVE

SOUTHCOTE ROAD

JOSEPHINE COURT

Kingswood
Court

Lesley Court

The Monastery

Probation Hostel

The Huntley
to
33

+ 58.2m

The material used in this plot has been reproduced from an Ordnance Survey map with the permission of the Controller of Her Majesty's Stationery Office © Crown copyright. Unauthorized reproduction infringes Crown copyright and may lead to prosecution or civil proceedings.

© Crown Copyright. All rights reserved. Reading Borough Council. Account No. 100019672. 2007



Department of Environment
Civic Centre
Reading
RG1 7TD

CAD DRAWING LOCATION:			
project WAITING RESTRICTION REVIEW 2016A			
drawing SOUTHCOTE ROAD			
drawn JC	checked JC	approved JC	date MAY 2016
scale N.T.S		drawing no. WRR16A/MI1	

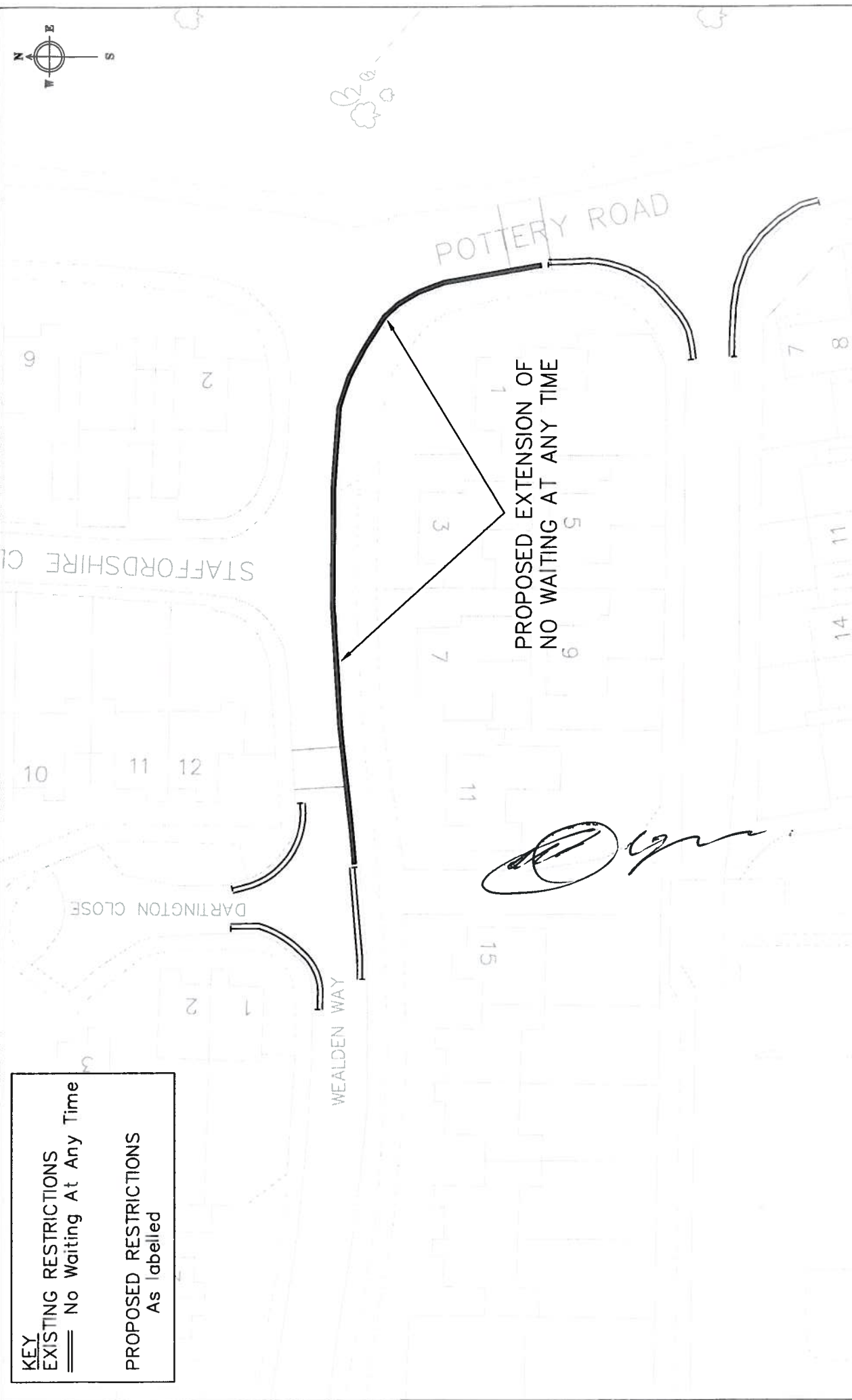
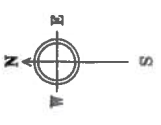

KEY
EXISTING RESTRICTIONS
 No Waiting At Any Time
PROPOSED RESTRICTIONS
 As labelled

Project Waiting Restrictions Review 2016A	Scale NTS	Drawn JC
	Date MAY 2016	Checked JC
Drawing No. WEALDEN WAY	Approved SB	WRR/2016A/KE4

Department of Environment
 and Neighbourhood Services
 Civic Centre
 Reading
 RG1 7AE



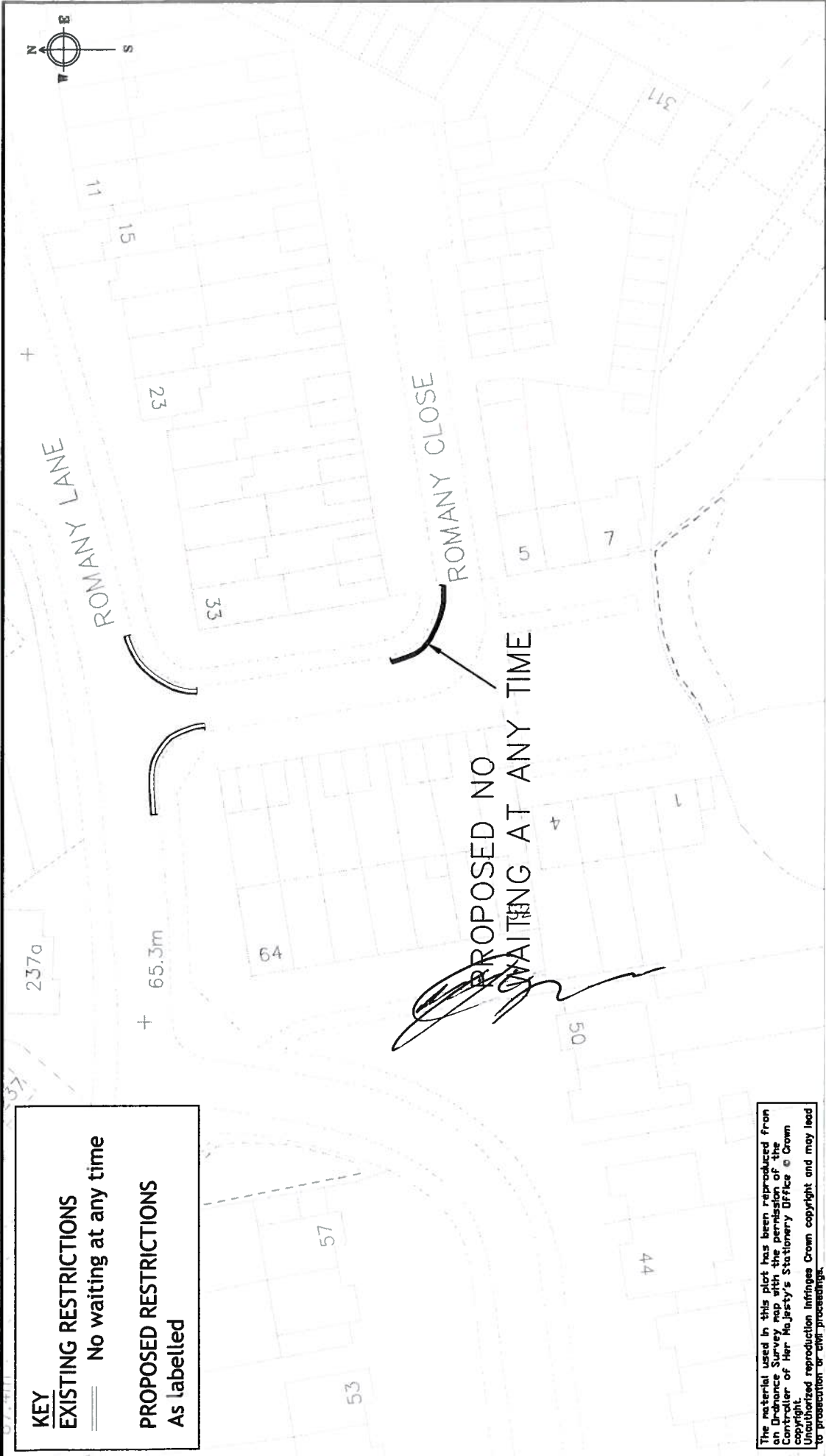

KEY
EXISTING RESTRICTIONS
 — No waiting at any time
PROPOSED RESTRICTIONS
 As labelled

The material used in this plot has been reproduced from an Ordnance Survey map with the permission of the Controller of Her Majesty's Stationary Office © Crown copyright. Unauthorized reproduction infringes Crown copyright and may lead to prosecution or civil proceedings.
 © Crown Copyright. All rights reserved. Reading Borough Council. Account No. 100019872. 2007



Department of Environment
 Culture and Sport
 Civic Centre
 Reading
 RG1 7TD

project WAITING RESTRICTION REVIEW 2016A		scale N.T.S		drawn JC approved JC		checked JC	
drawing ROMANLY CLOSE		drawing no. WRR16A/KE3		date MAY 2015			

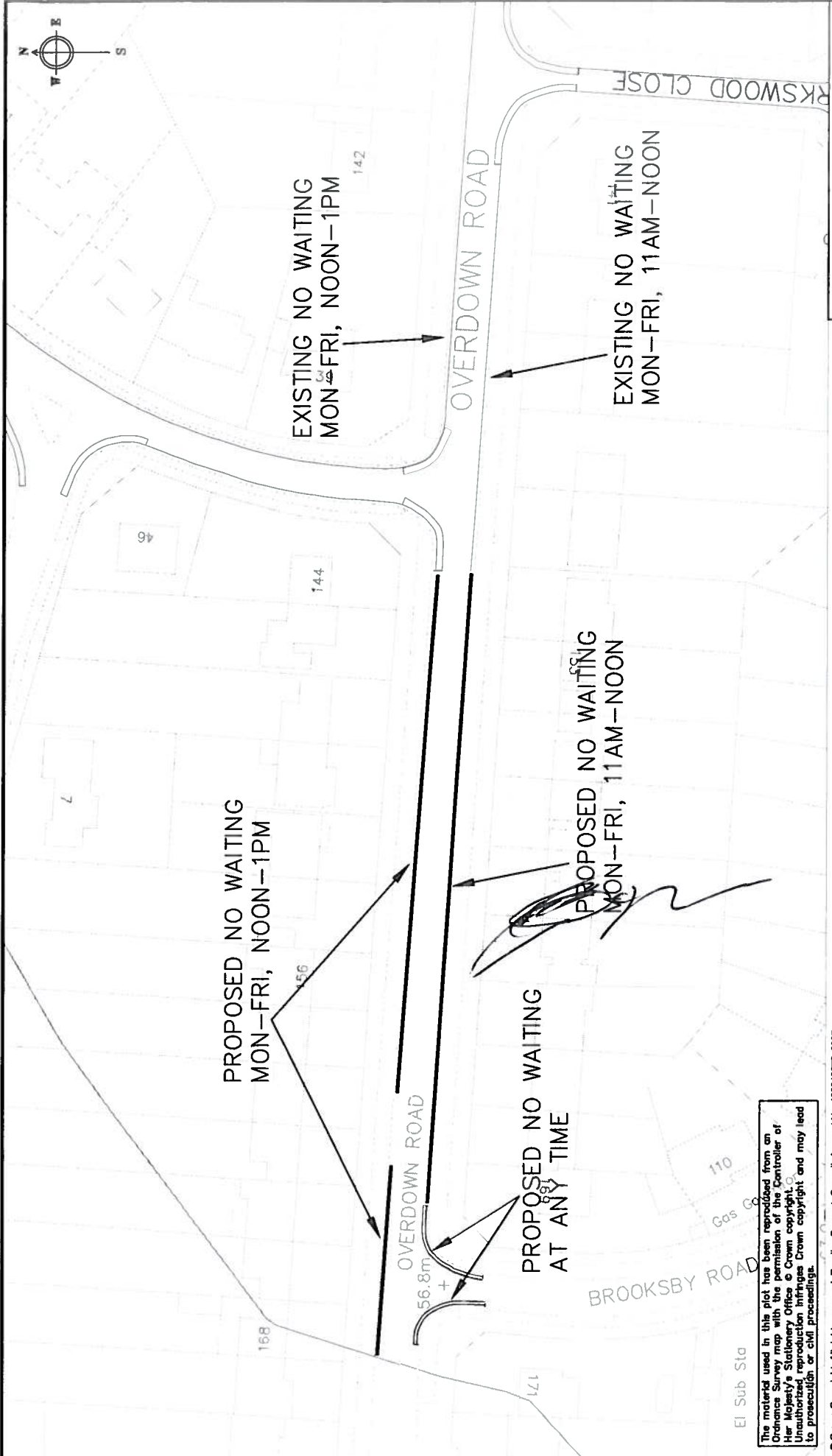

The material used in this plot has been reproduced from an Ordnance Survey map with the permission of the Controller of Her Majesty's Stationery Office © Crown copyright. Unauthorized reproduction infringes Crown copyright and may lead to prosecution or civil proceedings.

El Sub Sta

© Crown Copyright. All rights reserved. Reading Borough Council. Account No. 100019672. 2007

Department of Environment Culture and Sport Civic Centre Reading RG1 7TD		project WAITING RESTRICTION REVIEW 2016A		FAD Drawing Location: scale N.T.S	
S:\Drawing Frames\Reading.jpg		drawing OVERDOWN ROAD		drawn JC approved JC date MAY 2016	
				checked JC	
				drawing no. NM/WRR16A/KE2	

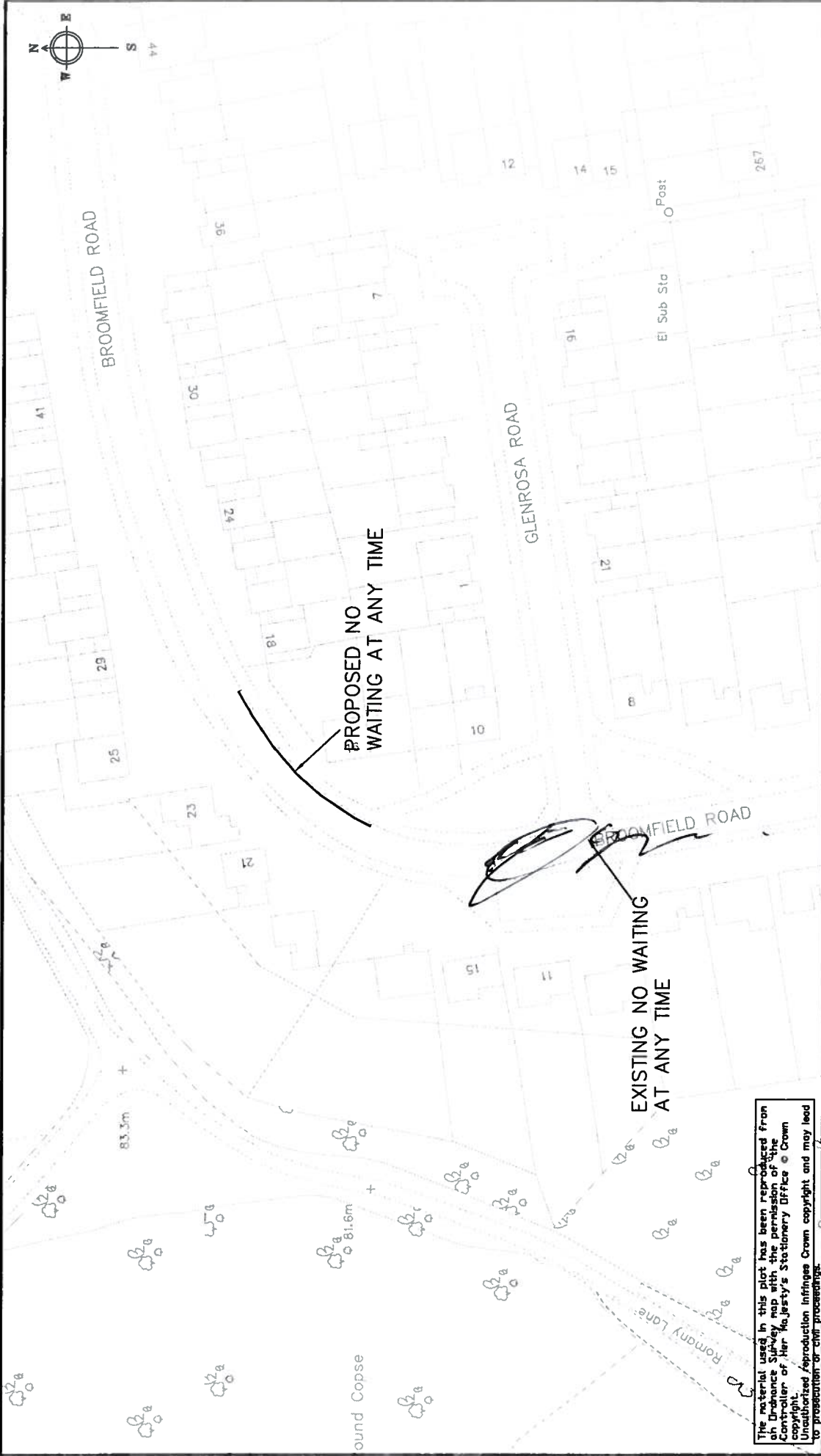
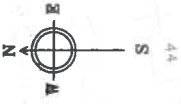

The material used in this plot has been reproduced from an Ordnance Survey map with the permission of the Controller of Her Majesty's Stationery Office © Crown copyright. Unauthorized reproduction infringes Crown copyright and may lead to prosecution or civil proceedings.

© Crown Copyright. All rights reserved. Reading Borough Council. Account No. 100019672. 2007

Department of Environment Culture and Sport Civic Centre Reading RG1 7TD		project WAITING RESTRICTION REVIEW 2016A		CAD Drawing Location scale N.T.S		drawn JC	checked JC
		drawing BROOMFIELD ROAD		drawing no. WRR16A/KE1		approved JC	date MAY 2016



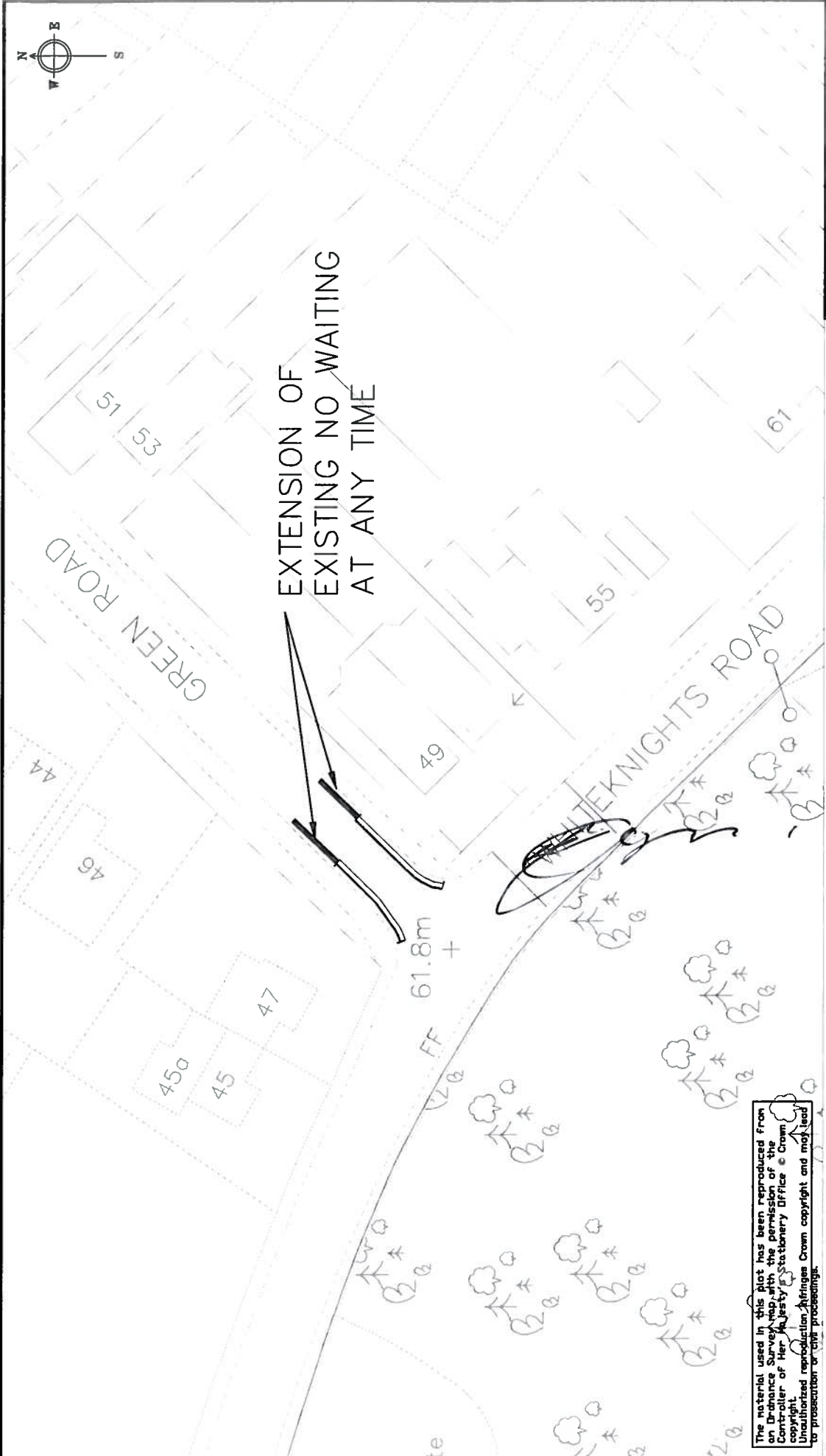

EXTENSION OF
EXISTING NO WAITING
AT ANY TIME

61.8m +

The material used in this plot has been reproduced from an Ordnance Survey map, with the permission of the Controller of Her Majesty's Stationery Office © Crown copyright. Unauthorised reproduction infringes Crown copyright and may lead to prosecution or civil proceedings.
© Crown Copyright. All rights reserved. Reading Borough Council. Account No. 100019672. 2007

Department of Environment Culture and Sport Civic Centre Reading RG1 7TD		project WAITING RESTRICTION REVIEW 2016A		CAD Drawing Location: scale N.T.S		drawn JC approved JC date MAY 2016	checked JC
 Reading BOROUGH COUNCIL		drawing GREEN ROAD		drawing no. WRR16A/PA2			



PROPOSED SHARED USE RP

P
 8am - 8pm
 Permit holders **12R**
 or
 2 hours
 No return
 within 4 hours
 At other times
 Permit holders
12R only

<p>Department of Environment and Neighbourhood Services Civic Centre Reading RG1 7AE</p>	<p>project</p> <p>Waiting Restrictions Review 2016A</p>	<p>scale</p> <p>NTS</p>	<p>drawn</p> <p>JC</p>	<p>checked</p> <p>JC</p>
	<p>drawing</p> <p>NEWTOWN AREA</p>	<p>drawing no.</p> <p>WRR/2016A/PA1</p>	<p>approved</p> <p>JC</p>	<p>date</p> <p>MAY 2016</p>



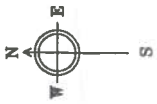

54

45

2

4

10

46

43

41

42

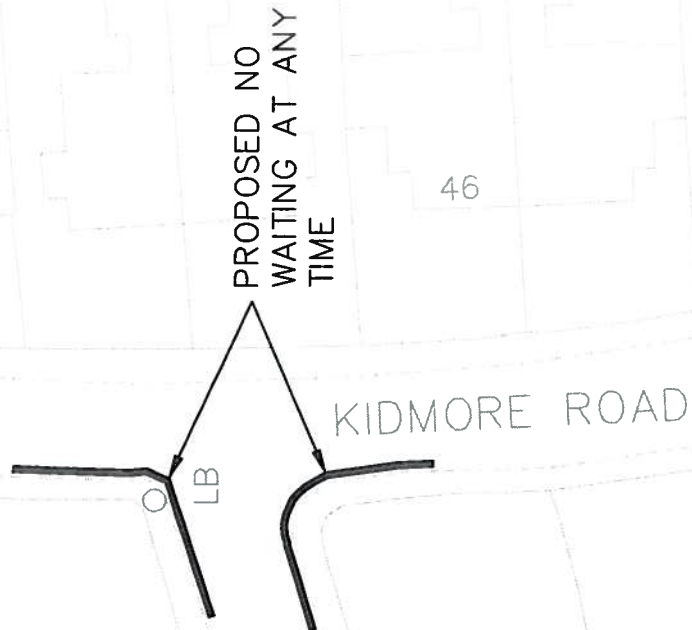

[Handwritten signature]

HIGHMOOR ROAD

KIDMORE ROAD

PROPOSED NO
WAITING AT ANY
TIME

LB

The material used in this plot has been reproduced from an Ordnance Survey map with the permission of the Controller of Her Majesty's Stationery Office © Crown copyright. Unauthorized reproduction infringes Crown copyright and may lead to prosecution or civil proceedings.

Crown copyright and database rights 2013 Ordnance Survey 100019672



Reading
Borough Council

Working better with you

Department of Environment
and Neighbourhood Services
Civic Centre
Reading
RG1 7AE

Project

WAITING RESTRICTION
REVIEW 2016A

Drawing
HIGHMOOR ROAD/
KIDMORE ROAD

Scale

N.T.S.
Date
MAY 16

Drawing No.

Drawn

JC
Checked
JC

Approved
JC

NM/AWRR/2016A/TH1

KEY

EXISTING RESTRICTIONS

— No waiting at any time

PROPOSED RESTRICTIONS

As labelled

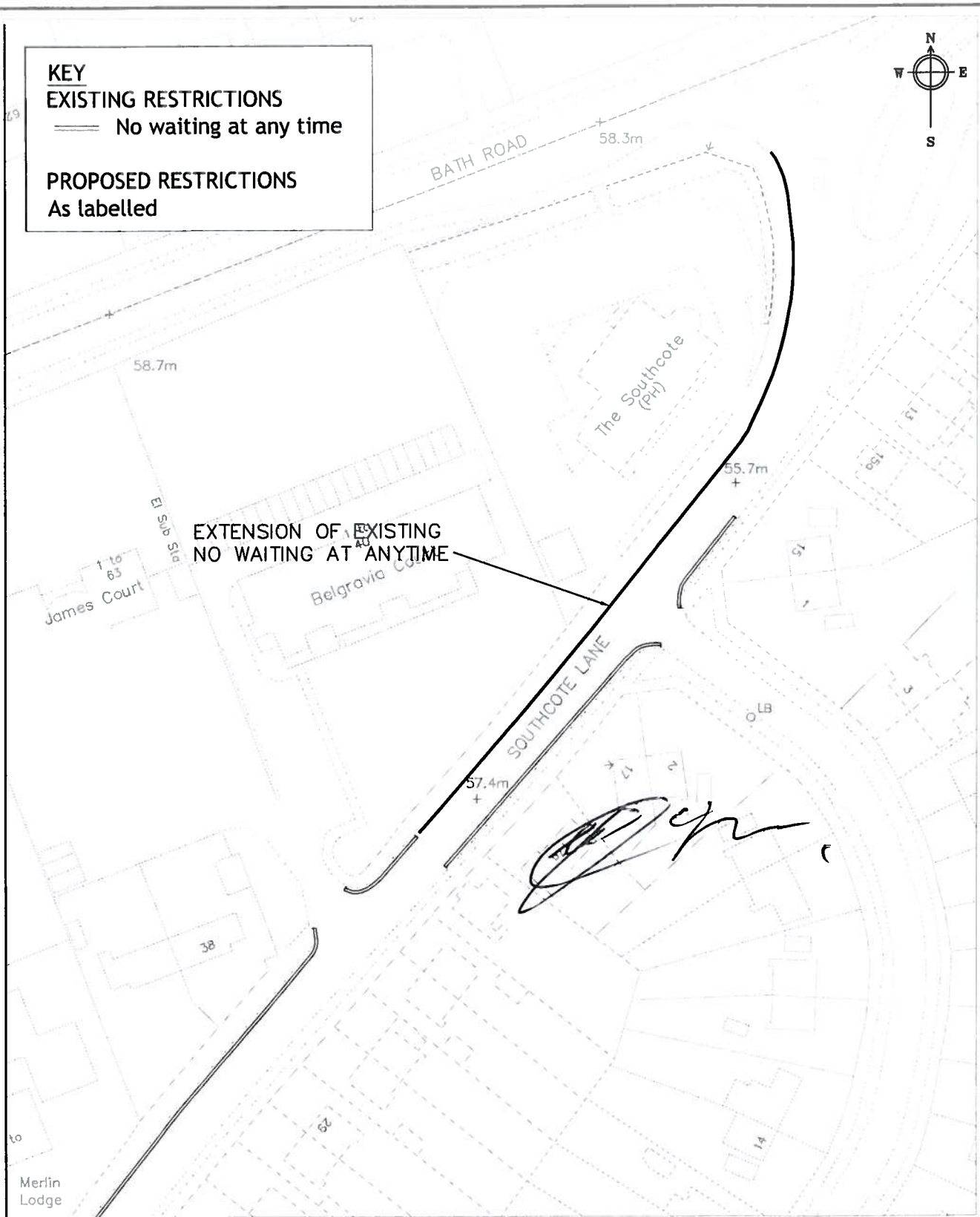

EXTENSION OF EXISTING
NO WAITING AT ANYTIME

Crown copyright and database rights 2013 Ordnance Survey 100019672



Reading
Borough Council

Working better with you

Department of Environment
Civic Centre
Reading
RG1 7TD

CAD DRAWING LOCATION:

project	WAITING RESTRICTION REVIEW 2016A		
drawing	SOUTHCOTE LANE		
drawn	checked	approved	date
JC	JC	SB	MAY 2016
scale	drawing no.		
N.T.S	WRR/2016A/SQ2		

LIST OF SCHEDULES

1. No waiting at any time
2. No waiting Mon to Fri 12pm-1pm
3. No Waiting Mon to Fri 11am - 12pm
4. Waiting limited to 30 minutes, return prohibited within 30 minutes Mon-Sat 8am-6.30pm.
5. Waiting limited to 2 hours, return prohibited within 2 hours. Mon-Sat 8am-6.30pm.
6. Waiting limited to 4 hours, Return prohibited within 2 hours, Mon-Fri, 8am-4pm
7. Shared use 8am-8pm, Permit holders or 2 hours limited waiting, no return within 4 hours. At all other times permit holders only
8. Residents' permit holders only - Monday to Sunday - 24 hours
9. List of residents for the issue of parking permits

**SCHEDULE 1
NO WAITING AT ANY TIME**

Gosbrook Road, South side

From a point 31m east of its junction with Patrick Road to a point 61m east of that junction.

Milford Road, East side

From a point 52m north of its junction with Meadow Road to a point 73m north of that junction.

Loverock Road, Northeast side

From a point 17 metres west of its junction with Little Johns Lane to a point 67m east of that junction.

Brybur Close, North side

From a point 10m west of its junction with Winton Road to a point 10m east of that junction.

Winton Road, both sides

From its junction with Brybur Close to a point 10m north of that junction.

Brybur Close, both sides

From its junction with Winton Road to a point 10m northwest of that junction.

Winton Road, Northwest side

From a point 10m northeast of its junction with Brybur Close to a point 10m southwest of that junction.

Ennerdale Road, both sides

From its junction with Northcourt Avenue to a point 15m west of that junction.

Northcourt Avenue, West side

From a point 15m north of its junction with Ennerdale Road to a point 10m south of that junction.

Broomfield Road, Southeast side

From a point 35m northeast of its junction with Glenrosa Road to a point 75m northeast of that junction.

Overdown Road, South side

From a point 10m west of its junction with Brooksby Road to a point 10m east of that junction.

Brooksby Road, both sides

From its junction with Overdown Road to a point 10m south of that junction.

Romany Close, North side

From a point 28m south of its junction with Romany Lane to a point 38m south of that junction.

Wealden Way, South side

From a point 40m west of its junction with Staffordshire Close to its junction with Pottery Road.

Pottery Road, West side

From its junction with Wealden Way to a point 22m south of that junction.

Southcote Road, West side

From a point 8m south of its junction with Carmelite Drive to a point 8m north of that junction.

Southcote Road, East side

From a point 10m north of its junction with Josephine Court to a point 10m south of that junction.

Josephine Court, both sides

From its junction with Southcote Road to a point 10m east of that junction.

Green Road, both sides

From its junction with Whiteknights Road to a point 16m northeast of that junction.

Galsworthy Drive, Southwest side

From a point 10m northwest of its junction with Montpelier Drive to a point 10m southeast of that junction.

Montpelier Drive, both sides

From its junction with Galsworthy Drive to a point 10m southwest of that junction.

Southcote Lane, Northwest side

From a point 126m southwest of its junction with Kenilworth Avenue to a point 96m north of that junction.

Highmoor Road, both sides

From its junction with Kidmore Road to a point 10m west of that junction.

Kidmore Road, West side

From a point 10m north of its junction with Highmoor Road to a point 10m south of that junction.

Church End Lane, West side

From a point 99m south of its junction with Stanham Road to a point 12m north of that junction.

Mayfair, Northeast side

From a point 33m southeast of its junction with Park Lane to a point 76m southeast of that junction.

Mayfair, Southwest side

From a point 33m southeast of its junction with Park Lane to a point 76m southeast of that junction.

St Michaels Road, Southwest side

From its junction with School Road to a point 162m southeast of that junction.

St Michaels Road, Northeast side

From its junction with School Road to a point 37m southeast of that junction.

St Michaels Road, Southwest side

From a point 32m northwest of its junction with Woodland Drive to a point 50m southeast of that junction.

Woodland Drive, both sides

From its junction with St Michaels Road to a point 10m southwest of that junction.

Crescent Road, both sides

From its junction with Westwood Road to a point 10m east of that junction.

Westwood Road, east side

From a point 10m north of its junction with Crescent Road to a point 10m south of that junction.

Portman Way, North side

From its junction with Portman Road to a point 69m east of that junction.

Portman Way, South side

From its junction with Portman Road to a point 22m east of that junction.

Portman Way, South side

From a point 10m west of its junction with Battle Square (Western Section) to a point 10m east of that junction.

Portman Way, South side

From its junction with Battle Square (Eastern Section) to a point 7m west of that junction.

Battle Square (Western Section) West side

From its junction with Portman Way to a point 15m south of that junction.

Battle Square (Western Section) East side

From its junction with Portman Way to a point 7m south of that junction.

Battle Square (Eastern Section) West side

From its junction with Portman Way to a point 7m south of that junction.

Battle Square (Eastern Section) West side

From a point 42m south of its junction with Portman Way to 109m south of that point.

Battle Square (Eastern Section) East side

From a point 55m south of its junction with Portman Way to its junction with Curzon Street.

Battle Square (Eastern Section) West side

From its junction with Curzon Street to a point 10m north of that junction.

Curzon Street, North side

From a point 13m east of its junction with Battle Place to a point 30m east of that junction.

Curzon Street, South side

From its junction with Battle Place to a point 35m east of that junction.

Curzon Street, South side

From its junction with Battle Place to a point 38m west of that junction.

Battle Place, both sides

From its junction with Curzon Street to a point 13m south of that junction.

**SCHEDULE 2
NO WAITING MON-FRI 12PM-1PM**

Overdown Road, North side

From a point 8m west of its junction with Brooksby Road to a point 10m west of its junction with Elsley Road.

**SCHEDULE 3
NO WAITING MON-FRI 11AM-12PM**

Overdown Road, South side

From a point 10m east of its junction with Brooksby Road to a point 15m west of its junction with Larkwood Close.

**SCHEDULE 4
WAITING LIMITED TO 30 MINUTES, RETURN PROHIBITED WITHIN 30 MINUTES MON-SAT 8AM-6.30PM**

St Michaels Road, Northeast side

From a point 37m southeast of its junction with School Road to a point 15m northwest of its junction with the Triangle.

**SCHEDULE 5
WAITING LIMITED TO 2 HOURS, RETURN PROHIBITED WITHIN 2 HOURS MON-SAT 8AM-6.30PM**

Gosbrook Road, South side

From a point 61m east of its junction with Patrick Road to a point 90m east of that junction.

SCHEDULE 6

WAITING LIMITED TO 4 HOURS, RETURN PROHIBITED WITHIN 2 HOURS, MON-FRI, 8am-4pm

Milford Road, West side

From a point 89m south of its junction with Cremyll Road to a point 98m south of that junction.

Milford Road, West side

From a point 66m south of its junction with Cremyll Road to a point 74m south of that junction.

Milford Road, West side

From a point 37m south of its junction with Cremyll Road to a point 59m south of that junction.

Milford Road, West side

From a point 17m south of its junction with Cremyll Road to a point 30m south of that junction.

SCHEDULE 7

MONDAY TO SUNDAY 8am-8pm 2 HOURS LIMITED WAITING NO RETURN WITHIN 4 HOURS OR PERMIT HOLDERS ONLY. AT OTHER TIMES PERMIT HOLDERS ONLY

Radstock Road, North Side

From a point 10m west of its junction with Liverpool Road to a point 3m east of its junction with Manchester Road.

Radstock Road, North Side

From a point 3m west of its junction with Manchester Road to a point 6m east of its junction with Cholmeley Road.

Radstock Road, South Side

From a point 4m west of its junction with Liverpool Road to a point 3m east of its junction with Manchester Road.

Radstock Road, South Side

From a point 3m west of its junction with Manchester Road to a point 7m east of its junction with Cholmeley Road.

Filey Road, North Side

From a point 3m west of its junction with Manchester Road to a point 10m east of its junction with Cholmeley Road.

Filey Road, South Side

From a point 3m west of its junction with Manchester Road to a point 20m east of its junction with Cholmeley Road.

Norton Road, North Side

From a point 3m west of its junction with Manchester Road to a point 10m east of its junction with Cholmeley Road.

Norton Road, South Side

From a point 3m west of its junction with Manchester Road to a point 10m east of its junction with Cholmeley Road.

Coventry Road North Side

From a point 9m west of its junction with Liverpool Road to a point 8m east of its junction with Cholmeley Road.

Coventry Road, South Side

From a point 3m west of its junction with Liverpool Road to a point 8m east of its junction with Cholmeley Road.

Freshwater Road, North Side

From a point 4m east of its junction with Cholmeley Road to a point 8m south west of its junction with Liverpool Road.

Freshwater Road, South Side

From a point 4m east of its junction with Cholmeley Road to a point 8m south west of its junction with Liverpool Road.

Manchester Road East Side

From a point 30m south of its junction with Liverpool Road to a point 8m north of its junction with Radstock Road.

Manchester Road East Side

From a point 5m south of its junction with Radstock Road for a distance of 56m.

Manchester Road West Side

From a point 5m south of its junction with Radstock Road for a distance of 56m.

Manchester Road East Side

From a point 6m south of its junction with Filey Road to a point 8m north of its junction with Radstock Road.

Manchester Road, West Side

From a point 9m south of its junction with Norton Road to a point 4m north of its junction with Filey Road.

Liverpool Road, West Side

From a point 6m north of its junction with Radstock Road to a point 5m south of its junction with Manchester Road.

Liverpool Road, West Side

From a point 6m north of its junction with Manchester Road to a point 5m south of its junction with Coventry Road.

Liverpool Road, West Side

From a point 9m north of its junction with Coventry Road to a point 5m south of its junction with Freshwater Road.

Liverpool Road, West Side

From a point 9m north of its junction with Freshwater Road to a point 5m south of its junction with Riversdale Court.

Liverpool Road, South West Side

From a point 5m northwest of its junction with Riversdale Court for a distance of 55m.

Liverpool Road, South Side

From a point 13m east of its junction with Cholmeley Road for a distance of 40m.

Liverpool Road, East Side

From a point 39m north of its junction with London Road for a distance of 44m.

Liverpool Road, East Side

From a point 108m north of its junction with London Road to a point 5m south of its junction with Jayworth House.

Liverpool Road, East Side

From a point 15m north of its junction with Jayworth House to a point 70m east of its junction with Cholmeley Road.

Liverpool Road, North Side

From a point 13m east of its junction with Cholmeley Road for a distance of 34m.

**SCHEDULE 8
RESIDENTS' PERMIT HOLDERS ONLY - MONDAY TO SUNDAY - 24 HOURS**

Gosbrook Road, South side

From a point 15m east of its junction with Patrick Road to a point 31m east of that junction.

SCHEDULE 9
LIST OF RESIDENTS FOR THE ISSUE OF PARKING PERMITS

RP Zone 12R

Radstock Road

Filey Road

Norton Road

Coventry Road

Freshwater Road

Manchester Road

Liverpool Road

RP Zone 01R

Gosbrook Road: numbers 2-64 even and 63-95 odds

